

DESCRIPTION:

JUNCTION BOX XL WITH COMP KIT

DRAWN BY:

mwatkins

SnapNrack™
Solar Mounting Solutions

PART NUMBER(S):

242-92121

REVISION:

A

595 MARKET STREET, 29TH FLOOR • SAN FRANCISCO, CA 94105 USA
PHONE (415) 580-6900 • FAX (415) 580-6902

THE INFORMATION IN THIS DRAWING IS CONFIDENTIAL AND PROPRIETARY. ANY REPRODUCTION, DISCLOSURE, OR USE THEREOF IS PROHIBITED WITHOUT THE WRITTEN CONSENT OF SUNRUN SOUTH LLC.

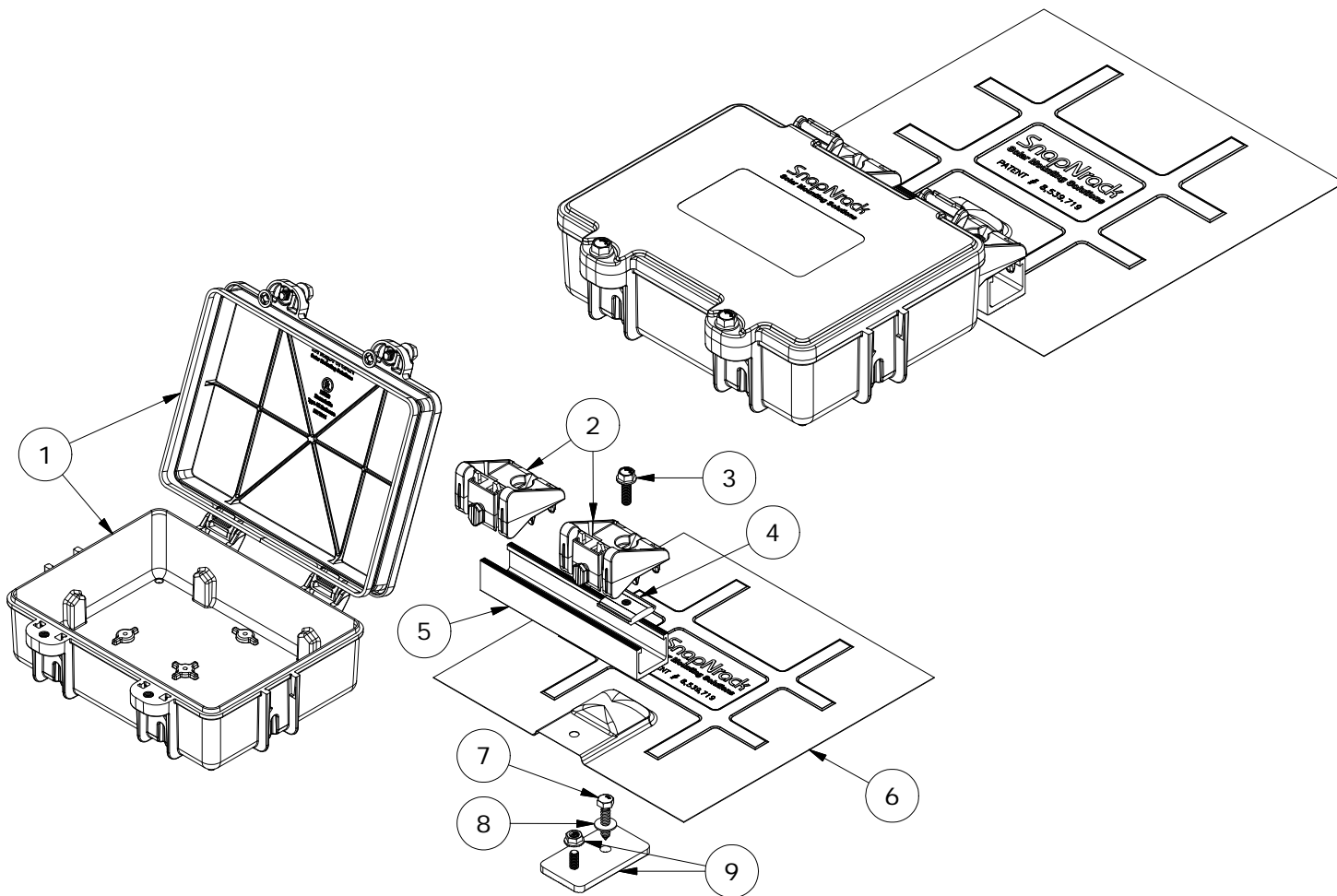

PARTS LIST

ITEM	QTY	DESCRIPTION
1	1	SNAPNRACK, JUNCTION BOX XL (BARE)
2	2	SNAPNRACK, J BOX TRACK BRACKET
3	1	BOLT, FLANGE, SERRATED, 5/16IN-18 X 1IN, SS
4	1	SNAPNRACK CHANNEL NUT 5/16IN-18
5	1	SNAPNRACK, FLASH TRACK, 7-1/2IN LENGTH, 5/16 BOLT HOLE, PLAIN ENDS
6	1	SNAPNRACK, L FOOT FLASHING, 12IN X 12IN, BLACK GALV
7	1	SCREW, LAG, 5/16IN X 1-1/2IN, HEX, SS
8	1	5/16IN X 3/4IN SS FLAT WASHER
9	1	SNAPNRACK, L FOOT BASE WITH NUT

MATERIALS:

POLYCARBONATE, CLOSED CELL FOAM, ALUMINUM, STAINLESS AND GALV. STEEL

DESIGN LOAD (LBS):

N/A

ULTIMATE LOAD (LBS):

N/A

TORQUE SPECIFICATION:

10 (FLANGE NUT), 5 (CHANNEL NUT), 3 (LID) LB-FT

CERTIFICATION:

UL50/UL50E, NEMA 4X RATING

WEIGHT (LBS):

5.21

DESCRIPTION:

JUNCTION BOX XL WITH COMP KIT

DRAWN BY:

mwatkins

REVISION:

A

SnapNrack™

Solar Mounting Solutions

PART NUMBER(S):

242-92121

595 MARKET STREET, 29TH FLOOR • SAN FRANCISCO, CA 94105 USA
PHONE (415) 580-6900 • FAX (415) 580-6902

THE INFORMATION IN THIS DRAWING IS CONFIDENTIAL AND PROPRIETARY. ANY REPRODUCTION, DISCLOSURE, OR USE THEREOF IS PROHIBITED WITHOUT THE WRITTEN CONSENT OF SUNRUN SOUTH LLC.

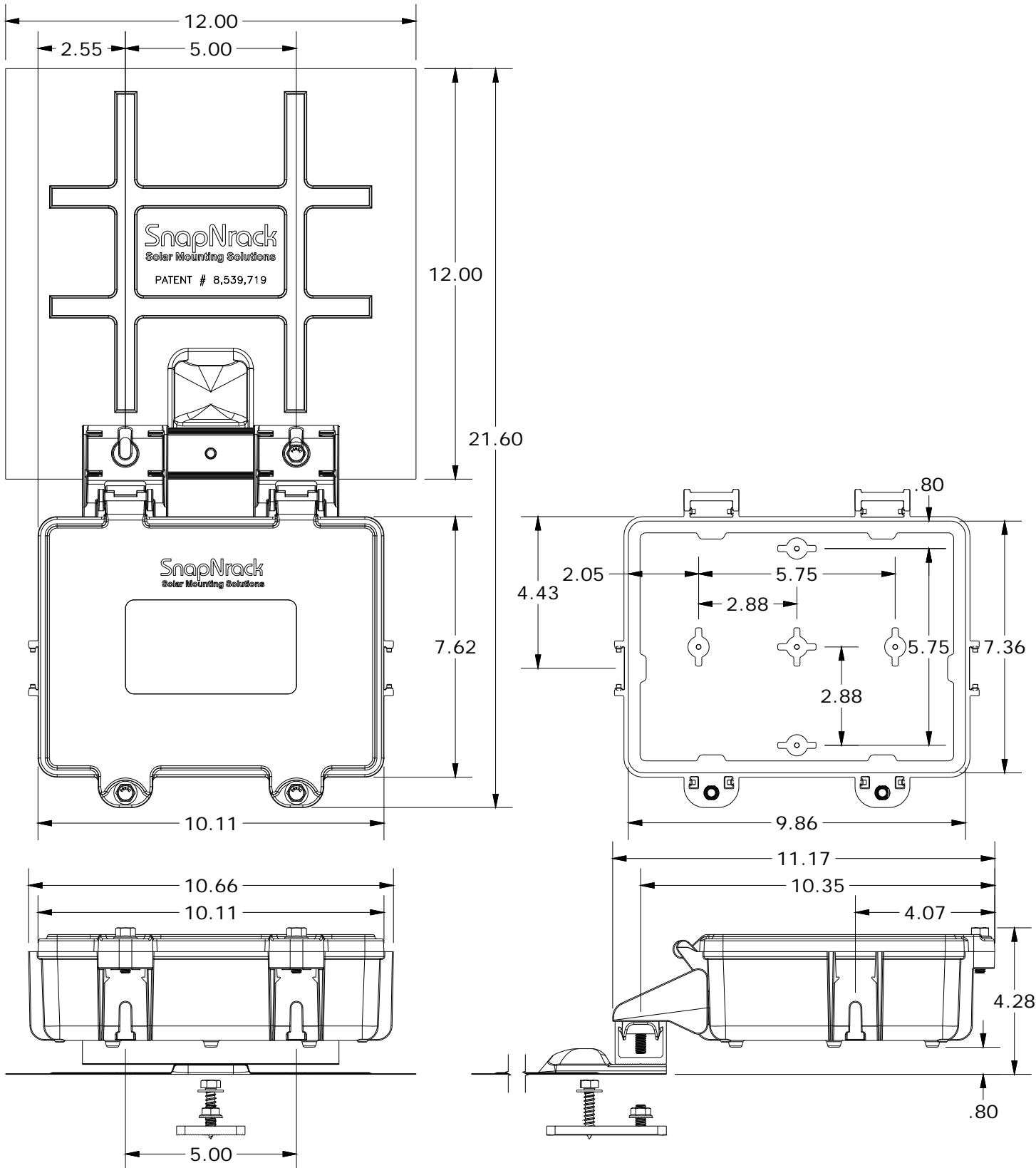

ALL DIMENSIONS IN INCHES