

DESCRIPTION:
JUNCTION BOX XL FOR RAIL

DOC NUMBER:
 SNR-DC-01384

SnapNrack®

PART NUMBER(S):
 242-92120

DRAWN BY:
 mwatkins

SUNRUN INSTALLATION SERVICES INC.

REV: **B** DATE: 1/20/2023

225 BUSH STREET, SUITE 1400 • SAN FRANCISCO, CA 94104 USA
 PHONE (877) 732-2860 • CONTACT@SNAPNRACK.COM
THE INFORMATION IN THIS DRAWING IS CONFIDENTIAL AND PROPRIETARY. ANY REPRODUCTION, DISCLOSURE, OR USE THEREOF IS PROHIBITED WITHOUT THE WRITTEN CONSENT OF SUNRUN SOUTH LLC.

UNITS: IN, LB, DEG [MM, KG, DEG] SHEET: 1:2

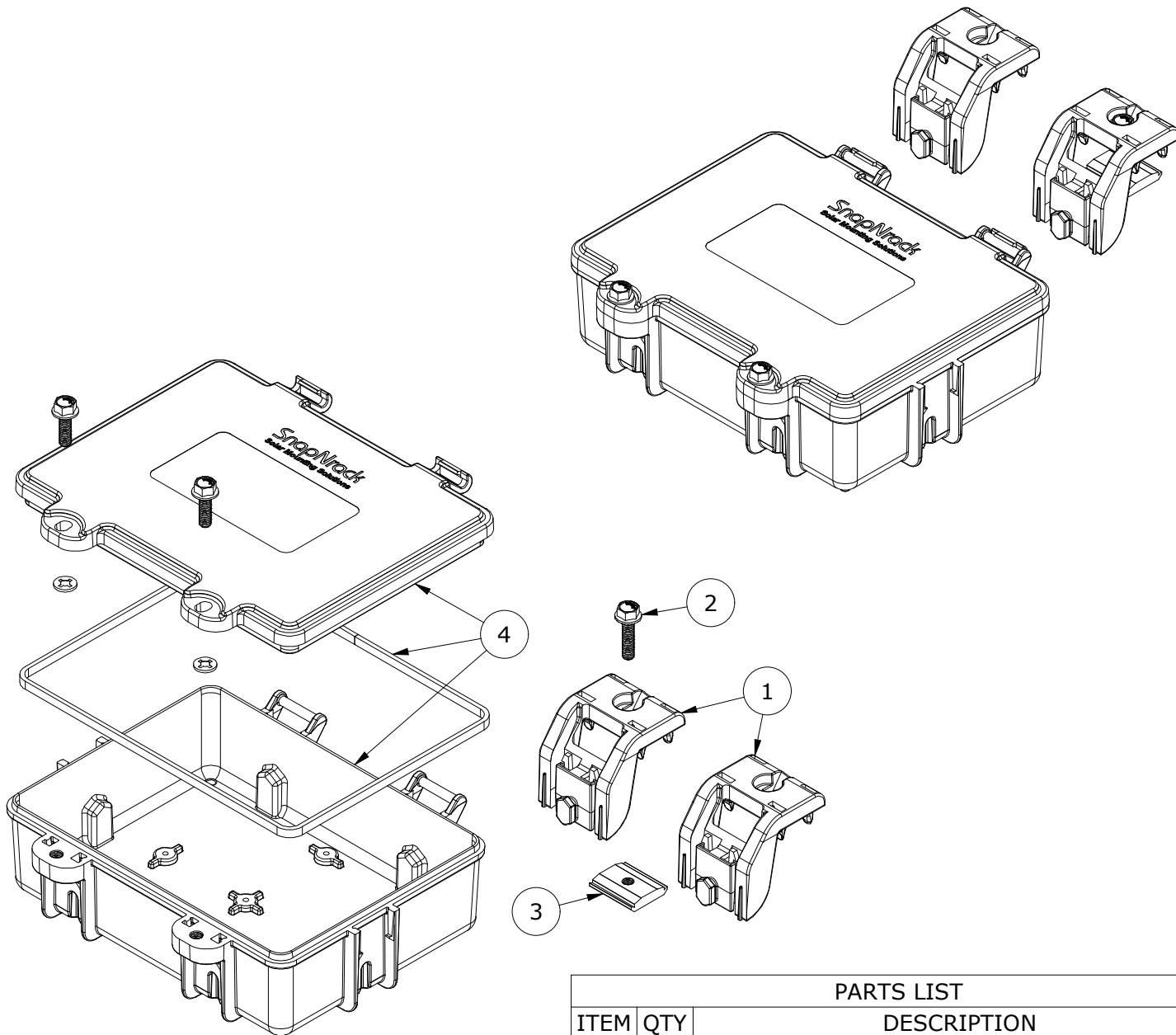

PARTS LIST

ITEM	QTY	DESCRIPTION
1	2	SNAPNRACK, J BOX RAIL BRACKET
2	1	BOLT, FLANGED HEX, 5/16IN-18 X 1-1/4IN, SS
3	1	SNAPNRACK CHANNEL NUT 5/16IN-18
4	1	SNAPNRACK, JUNCTION BOX XL (BARE)

MATERIALS: POLYCARBONATE, CLOSED CELL FOAM, ALUMINUM, STAINLESS STEEL

DESIGN LOAD (LBS): N/A

ULTIMATE LOAD (LBS): N/A

TORQUE SPECIFICATION: 5 (CHANNEL NUT), 3 (LID) FT-LBS

CERTIFICATION: UL50/UL50E, NEMA 4X RATING

WEIGHT (LBS): 3.80

DESCRIPTION:

JUNCTION BOX XL FOR RAIL

DOC NUMBER:

SNR-DC-01384

SnapNrack®

DRAWN BY:

mwatkins

PART NUMBER(S):

242-92120

REV:

B

DATE:

1/20/2023

SUNRUN INSTALLATION SERVICES INC.

225 BUSH STREET, SUITE 1400 • SAN FRANCISCO, CA 94104 USA
PHONE (877) 732-2860 • CONTACT@SNAPNRACK.COM

THE INFORMATION IN THIS DRAWING IS CONFIDENTIAL AND PROPRIETARY. ANY REPRODUCTION, DISCLOSURE, OR USE THEREOF IS PROHIBITED WITHOUT THE WRITTEN CONSENT OF SUNRUN SOUTH LLC.

UNITS: IN, LB, DEG [MM, KG, DEG]

SHEET: 2:2

