

SNAPNRACK ADJUSTABLE TILE HOOK FOR USE WITH SNAPNRACK ULTRA RAIL
 TILE ROOF MOUNT ASSEMBLY MAY BE USED FOR S, W, AND FLAT TILE PROFILE ROOFS
 REFER TO SNAPNRACK ENGINEERING CHARTS FOR APPLICABLE RAIL SPANS. "BIN"
 NUMBER ON CHART SHOULD MATCH "BIN" NUMBER ON THIS DRAWING

$\frac{5}{16}$ " \varnothing S.S. LAG SCREWS MUST EMBED A MIN. OF $2\frac{1}{2}$ " INTO STRUCTURAL MEMBER

REFER TO SNAPNRACK INSTALLATION MANUAL FOR $\frac{5}{16}$ " \varnothing HARDWARE TORQUE

SPECIFICATIONS UNLESS STATED OTHERWISE

RAIL MAY BE MOUNTED TO THE UPSLOPE OR DOWNSLOPE SIDE OF THE TILE HOOK

RAILS CAN BE LEVELED UP TO $1\frac{1}{4}$ " USING THE SLOT IN THE TILE HOOK

TILE HOOK ARM CAN BE LEVELED $\frac{7}{16}$ " RELATIVE TO THE BASE

STRUCTURAL MEMBER SPECIFICATIONS:

- MINIMUM WOOD GRADE = SPF #2
- MINIMUM SPECIFIC GRAVITY = 0.42
- ALLOWABLE FASTENER UPLIFT = 820 LBS
- ALLOWABLE FASTENER LATERAL = 250 LBS
- MINIMUM FASTENER EDGE DISTANCE = 0.5"
- MINIMUM FASTENER END DISTANCE = 2.2"

BIN: **1**

REVISION:			
1	2/6/2020	NEW DETAIL	DR
2	11/6/2020	EDITED NOTES	DR
2	5/12/2021	TEXT CORR.	DR

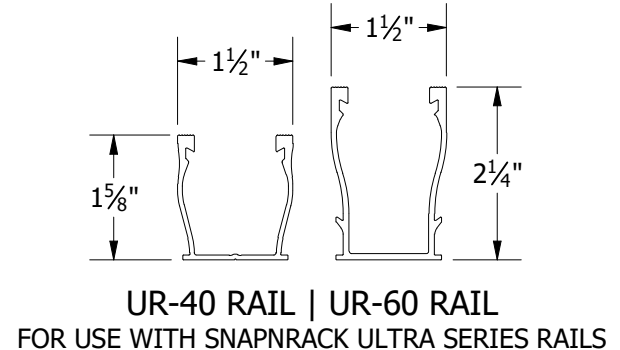
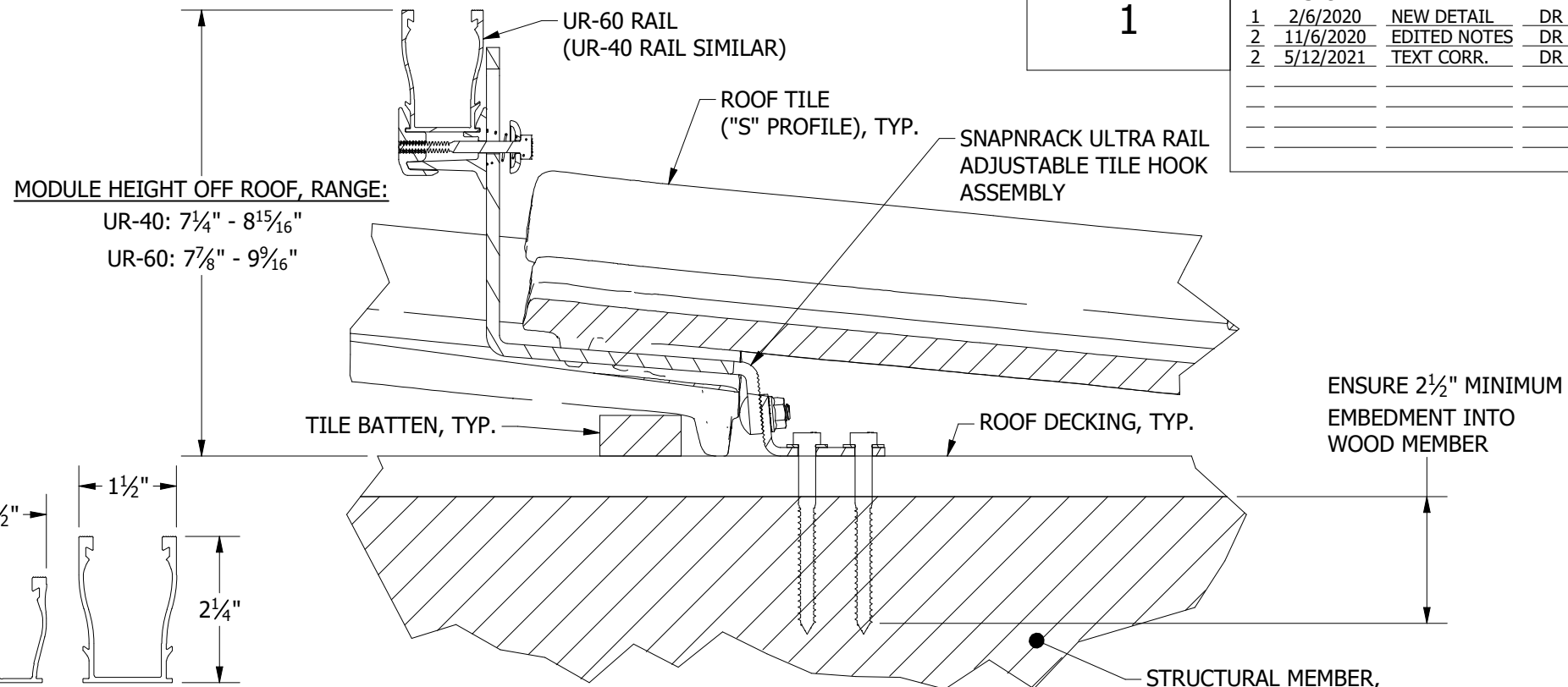

ATTACHMENT DETAIL

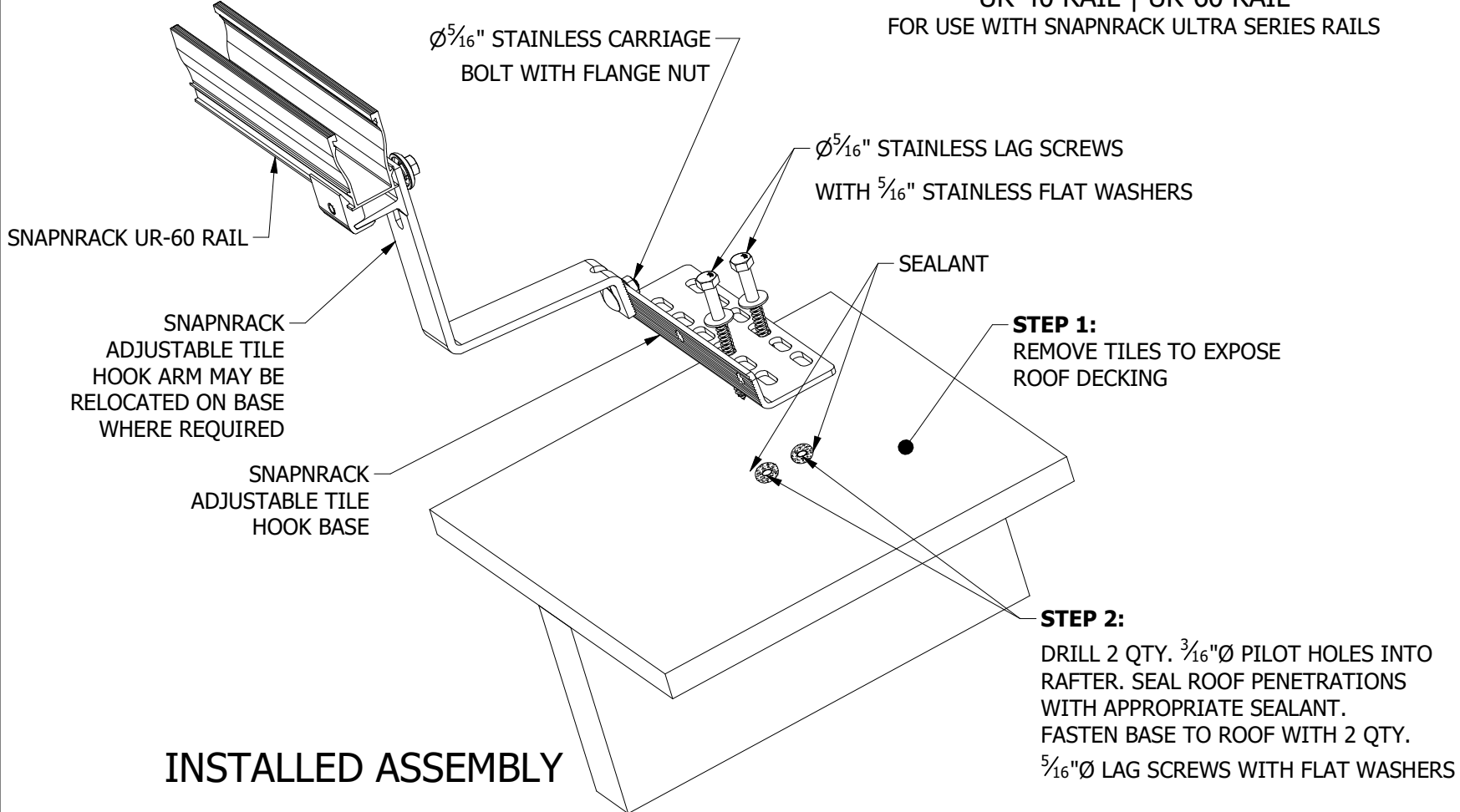

INSTALLED ASSEMBLY

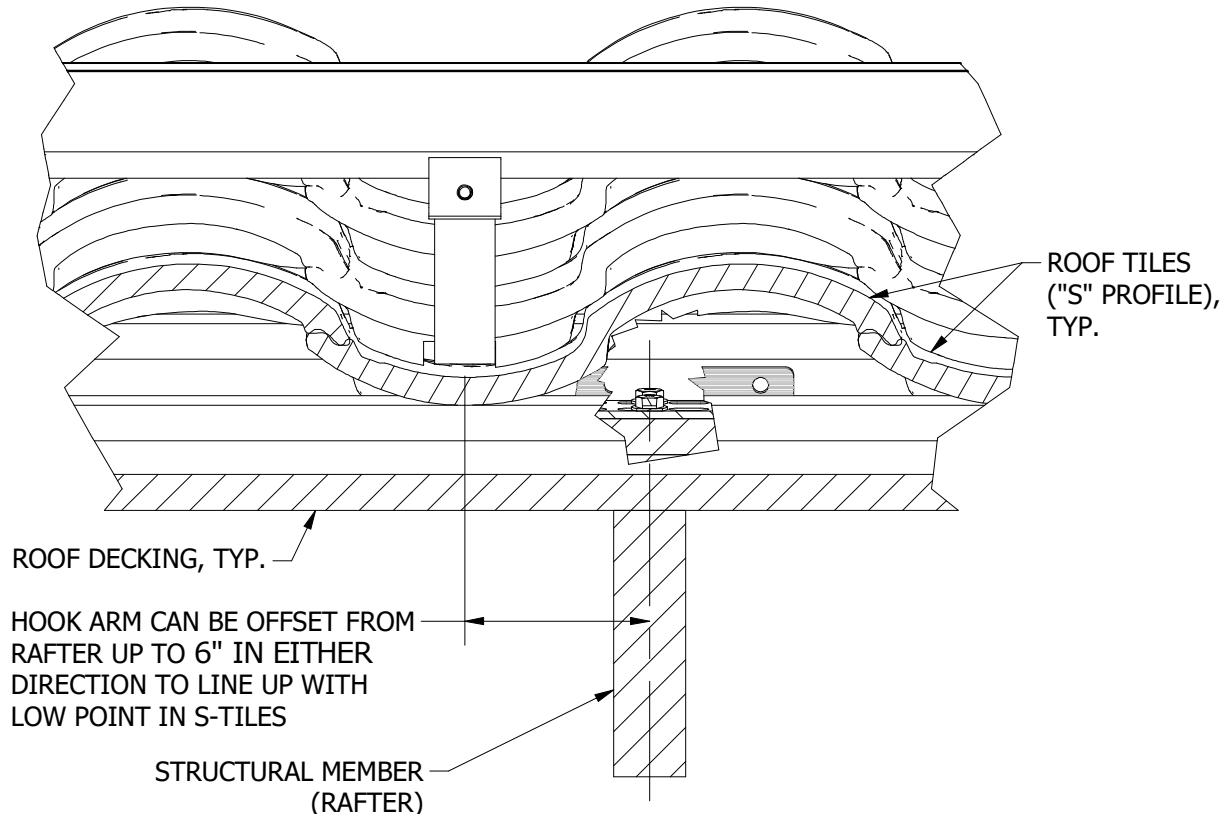

OFFSET DETAIL