

SNAPNRACK UR SPEEDSEAL FOOT FOR COMPOSTION ROOF MOUNTING

MODULE HEIGHT OFF ROOF, RANGE:

UR-40: 3<sup>3</sup>/<sub>8</sub>" - 4<sup>3</sup>/<sub>8</sub>"

UR-60: 4" - 5"

REFER TO SNAPNRACK ENGINEERING CHARTS FOR APPLICABLE RAIL SPANS.

\*ALTERNATE FASTENERS AND STRUCTURAL SUBSTRATES ARE PERMITTED. SNAPNRACK'S STANDARD ENGINEERING REQUIRES MINIMUM FASTENER ALLOWABLE CAPACITIES OF **532 LBS** WITHDRAWAL AND **270 LBS** SHEAR. CAPACITIES LOWER THAN THIS WILL REQUIRE SITE-SPECIFIC ENGINEERING

REFER TO SNAPNRACK INSTALLATION MANUAL FOR 5/16"Ø HARDWARE TORQUE SPECIFICATIONS

SNAPNRACK SPEEDSEAL FOOT CAN MOUNT IN ANY ORIENTATION ON THE ROOF

BIN: 8

REVISION:

1	3/10/2020	NEW DETAIL	MJA
2	6/5/2020	DIE CAST	BDP
3	7/22/2020	NAME UPDATE	MJA
4	10/2/2020	MIAMI-DADE	MJA
B	8/2/2021	DC000595	MJA
C	3/29/2023	DC001948	MKW

\*MINIMUM EMBEDMENT, VARIES TO MEET MINIMUM CAPACITY REQUIREMENTS

PENETRATION DETAIL

SNAPNRACK ULTRA RAIL MOUNT, TAPPED

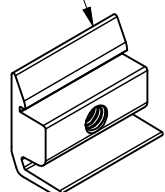

SNAPNRACK, ULTRA RAIL MOUNT, THRU

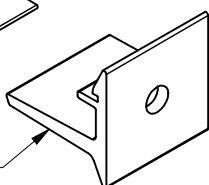

SNAPNRACK, SPEEDSEAL FOOT, BASE, SEALING

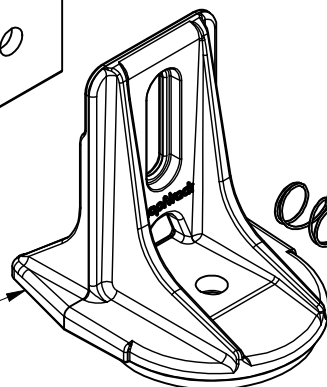

EXPLODED

COIL SPRING FOR 3/8" Ø BOLT, S.S. OPTIONAL

5/16" FLAT WASHER, S.S. OPTIONAL

5/16"Ø-18 X 2" BOLT, SERRATED FLANGE, S.S.

CAVITY IN UR SPEEDSEAL FOOT IS FILLED WITH SEALANT TO ENCAPSULATE AND PROTECT THE ROOF PENETRATION FROM MOISTURE

5/16" WASHER, S.S. (MAY INCLUDE NEOPRENE TYPE GASKET)

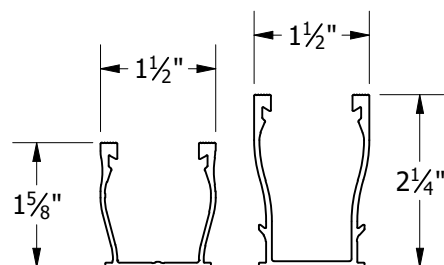

UR-40 RAIL | UR-60 RAIL

FOR USE WITH SNAPNRACK ULTRA SERIES RAILS

