

DESCRIPTION:  
**SNAPNRACK, TDS, SPEEDSEAL JUNCTION BOX S, COMP KIT**

DOC NUMBER:  
 SNR-DC-01349

**SnapNrack®**

PART NUMBER(S):

242-92129

DRAWN BY:  
 H.WULFEKOETTER

REV: **B**      DATE: 1/20/2023

SUNRUN INSTALLATION SERVICES INC.  
 225 BUSH STREET, SUITE 1400 • SAN FRANCISCO, CA 94104 USA  
 PHONE (877) 732-2860 • CONTACT@SNAPNRACK.COM  
THE INFORMATION IN THIS DRAWING IS CONFIDENTIAL AND PROPRIETARY. ANY REPRODUCTION, DISCLOSURE, OR USE THEREOF IS PROHIBITED WITHOUT THE WRITTEN CONSENT OF SUNRUN SOUTH LLC.

UNITS: IN, LB, DEG [MM, KG, DEG]

SHEET: 1:2

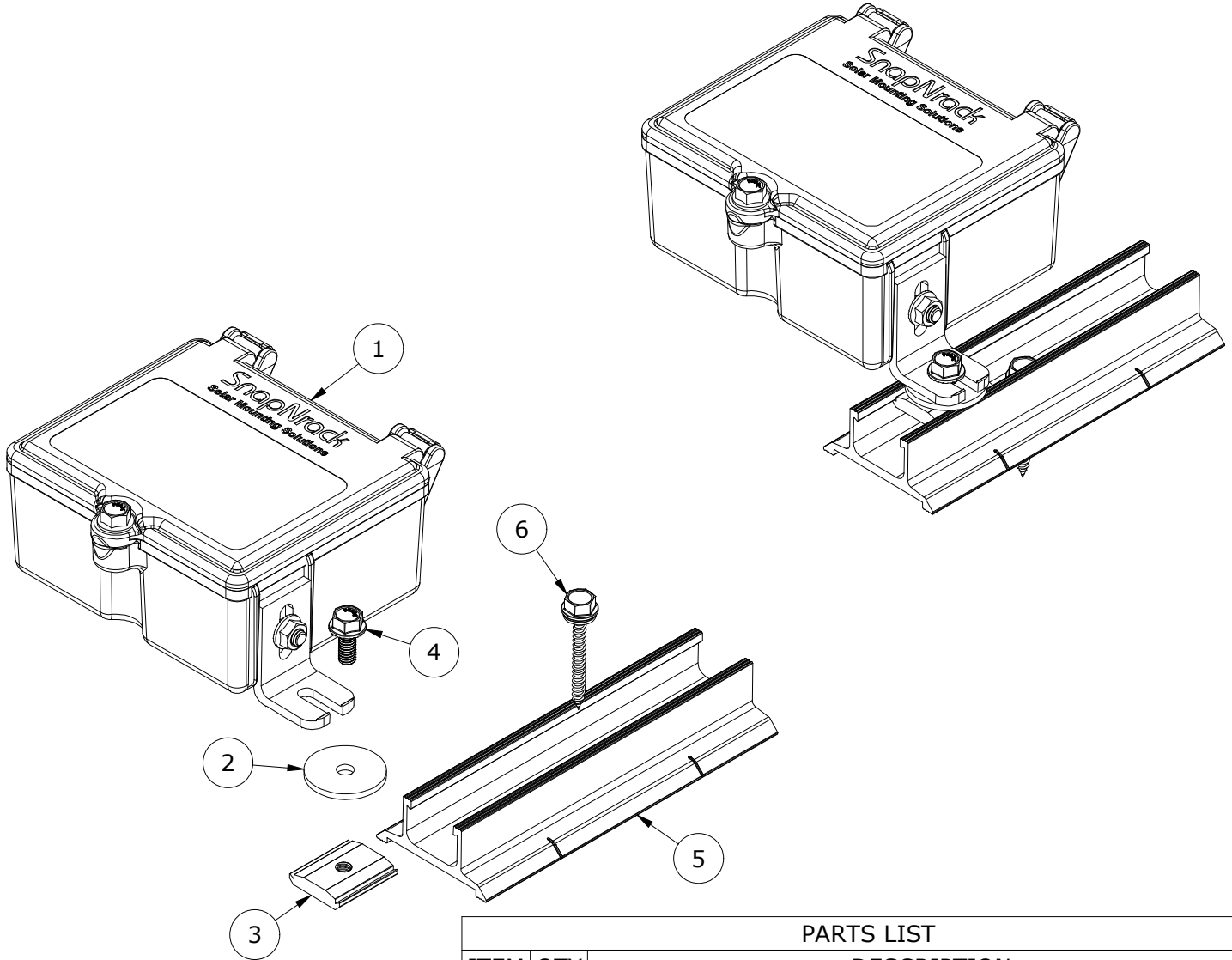

PARTS LIST		
ITEM	QTY	DESCRIPTION
1	1	SNAPNRACK, JUNCTION BOX RL
2	1	WASHER, FENDER, 5/16IN X 1-1/2 X .125IN, SS
3	1	SNAPNRACK CHANNEL NUT 5/16IN-18
4	1	BOLT, FLANGE, 5/16IN-18 X 3/4IN, CLEAR, SS
5	1	SNAPNRACK, SPEEDSEAL TRACK, 7-1-2IN, SEALING, MILL
6	1	SNAPNRACK, SEALING WASHER WOOD SCREW, #14 X 2-1-4IN, 1-2IN HEX HEAD, SS

MATERIALS:	POLYCARBONATE, RUBBER, ALUMINUM, STAINLESS STEEL, FOAM
DESIGN LOAD (LBS):	N/A
ULTIMATE LOAD (LBS):	N/A
TORQUE SPECIFICATION:	12 (CHANNEL NUT), 5 (L FOOT TO BOX), 3 (LID) LB-FT FT-LBS
CERTIFICATION:	UL50, NEMA 4X RATING
WEIGHT (LBS):	1.89

DESCRIPTION:  
**SNAPNRACK, TDS, SPEEDSEAL JUNCTION BOX S, COMP KIT**

DOC NUMBER:  
 SNR-DC-01349

SnapNrack®

PART NUMBER(S):

242-92129

DRAWN BY:  
 H.WULFEKOETTER

REV: **B**      DATE:  
 1/20/2023

SUNRUN INSTALLATION SERVICES INC.

225 BUSH STREET, SUITE 1400 • SAN FRANCISCO, CA 94104 USA  
 PHONE (877) 732-2860 • CONTACT@SNAPNRACK.COM

THE INFORMATION IN THIS DRAWING IS CONFIDENTIAL AND PROPRIETARY. ANY REPRODUCTION, DISCLOSURE, OR USE THEREOF IS PROHIBITED WITHOUT THE WRITTEN CONSENT OF SUNRUN SOUTH LLC.

UNITS: IN, LB, DEG [MM, KG, DEG]

SHEET: 2:2

