

DESCRIPTION:  
**SNAPRACK, TDS, ULTRA RAIL END CLAMP,  
 BLACK (USA)**

DOC NUMBER:  
 SNR-DC-01441

**SnapNrack®**

PART NUMBER(S):  
 242-02073-USA

DRAWN BY:  
 M.AFFENTRANGER

SNR SOLAR LLC  
 775 FIERO LANE, SUITE 200  
 SAN LUIS OBISPO, CA 93401 USA  
 EMAIL: CONTACT@SNAPNRACK.COM  
THE INFORMATION IN THIS DRAWING IS CONFIDENTIAL AND PROPRIETARY. ANY REPRODUCTION, DISCLOSURE, OR USE THEREOF IS PROHIBITED WITHOUT THE WRITTEN CONSENT OF SUNRUN SOUTH LLC.

UNITS: IN, LB, DEG [MM, KG, DEG]      SHEET: 1:2

REV:      DATE:  
**A**      11/18/2024

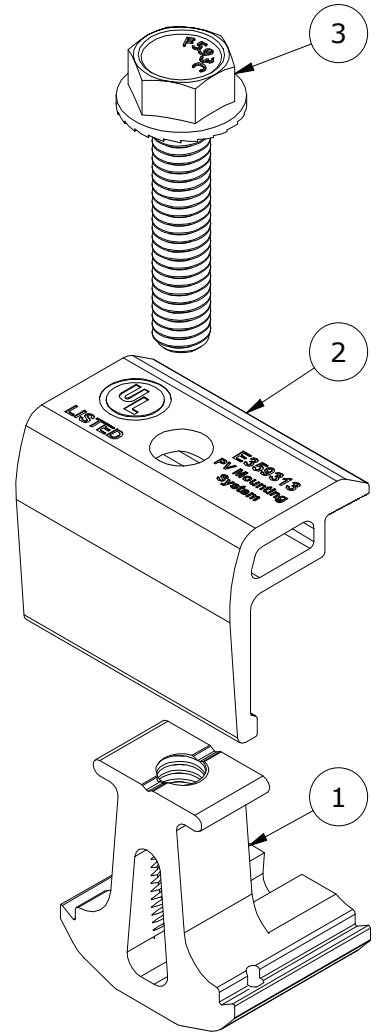
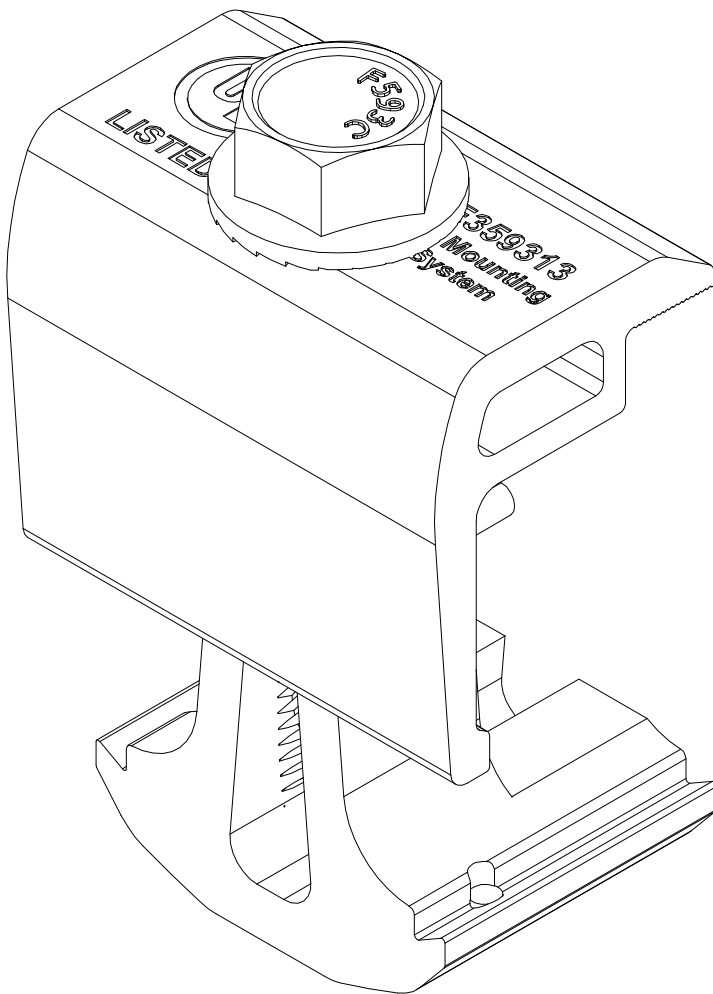

NOTE:  
 CLAMPS FIT 30-46MM THICK MODULE FRAMES

PARTS LIST		
ITEM	QTY	DESCRIPTION
1	1	SNAPRACK, ULTRA RAIL END CLAMP, BASE
2	1	SNAPRACK, ULTRA RAIL END CLAMP, TOP, BLACK
3	1	BOLT, FLANGE SERRATED, 5/16IN-18 X 1-1/2IN, SS

MATERIALS:	6000 SERIES ALUMINUM, STAINLESS STEEL
DESIGN LOAD (LBS):	520
ULTIMATE LOAD (LBS):	2000
TORQUE SPECIFICATION:	16 FT-LBS
CERTIFICATION:	UL 2703, FILE E359313; DOMESTIC CONTENT COMPLIANT
WEIGHT (LBS):	0.16