

SnapNrack®

UltraFoot™

The Ultimate Attachment for Ultra Rail



New Flip Clamp Mount that centers load over fastener & creates an easier snap-in experience with UR-45 Rail

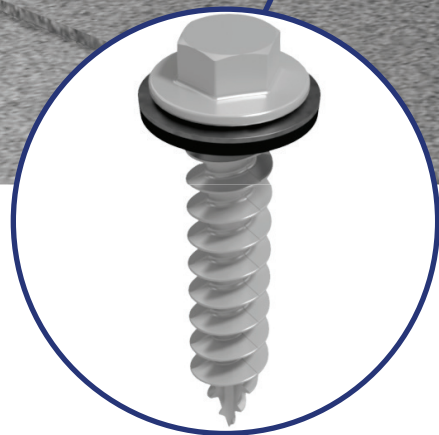

Proprietary fastener reduces the number of screws for deck mounting & increases torque-out strength by 600% compared to #14 wood screws



Features **SpeedSeal™+ Technology**, a pre-installed butyl pad for easy peel & stick installation

Start Installing UltraFoot Today

Flexible Rafter & Deck Mounting Options

- UltraFoot available in (3) configurations to accommodate rafter & deck mounting based on DeckAnchor™ or wood screw install preferences
- The only single lag roof attachment with butyl sealing available
- Compatible with pitched roofs and low sloped to flat roofs
- Available in domestic content options, refer to “-USA” SKUs



UltraFoot, Rafter

242-10056 & 242-10056-USA

- Installs with (1) Sealing Washer Lag, 242-02168



UltraFoot, Deck

242-10057 & 242-10057-USA

- Installs with (2) Sealing Wood Screws, 242-10010, for rafter mounting or (4) Sealing Wood Screws for deck mounting



UltraFoot, Anchor

242-10058 & 242-10058-USA

- Installs with (1) Sealing Washer Lag, 242-02168, for rafter mounting or (2) DeckAnchors, 242-10035

New! Flip Clamp Mount

- Ships pre-assembled, eliminating T-Bolts
- Allows UR-45 Rail to easily slide & level within the mount.
- Positions the load over the fasteners for a stronger roof attachment



Patented SpeedSeal+ Technology

- 0.25” thick industry-leading pre-applied butyl
- Innovative bottom design features recessed edges with butyl for firm contact with roof & prevents butyl from squeezing out over time
- Creates a watertight seal over all the roof surfaces, including across shingle tabs
- TAS 100A Wind Driven Rain Testing

Proprietary DeckAnchor Fasteners

- Wide threads securely grip the wood deck & significantly reduces the potential for over-tightening
- Reduces the required screw count in half for deck mounting & increases the torque-out strength by 600% compared to a standard #14 wood screw
- ASTM D1761 Screw Capacities
- ½” hex head to maintain the SnapNrack tradition of a single tool install

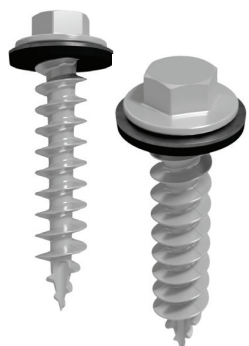

SnapNrack®

877-732-2860

www.snapnrack.com

contact@snapnrack.com

© 2025 by SnapNrack Solar Mounting Solutions. All rights reserved