

DESCRIPTION:
SNAPNRACK, TDS, MLPE FRAME ATTACHMENT
KIT (USA)

PART NUMBER(S):

242-02151-USA

UNITS: IN, LB, DEG [MM, KG, DEG]

SHEET: 1:2

DOC NUMBER:
SNR-DC-01462

DRAWN BY:
M.WATKINS

REV:

A

DATE:

2/18/2025

SnapNrack®

SNR SOLAR LLC

775 FIERO LANE, SUITE 200, SAN LUIS OBISPO, CA 93401 USA
EMAIL: CONTACT@SNAPNRACK.COM

THE INFORMATION IN THIS DRAWING IS CONFIDENTIAL AND PROPRIETARY. ANY
REPRODUCTION, DISCLOSURE, OR USE THEREOF IS PROHIBITED WITHOUT THE
WRITTEN CONSENT OF SNR SOLAR LLC.

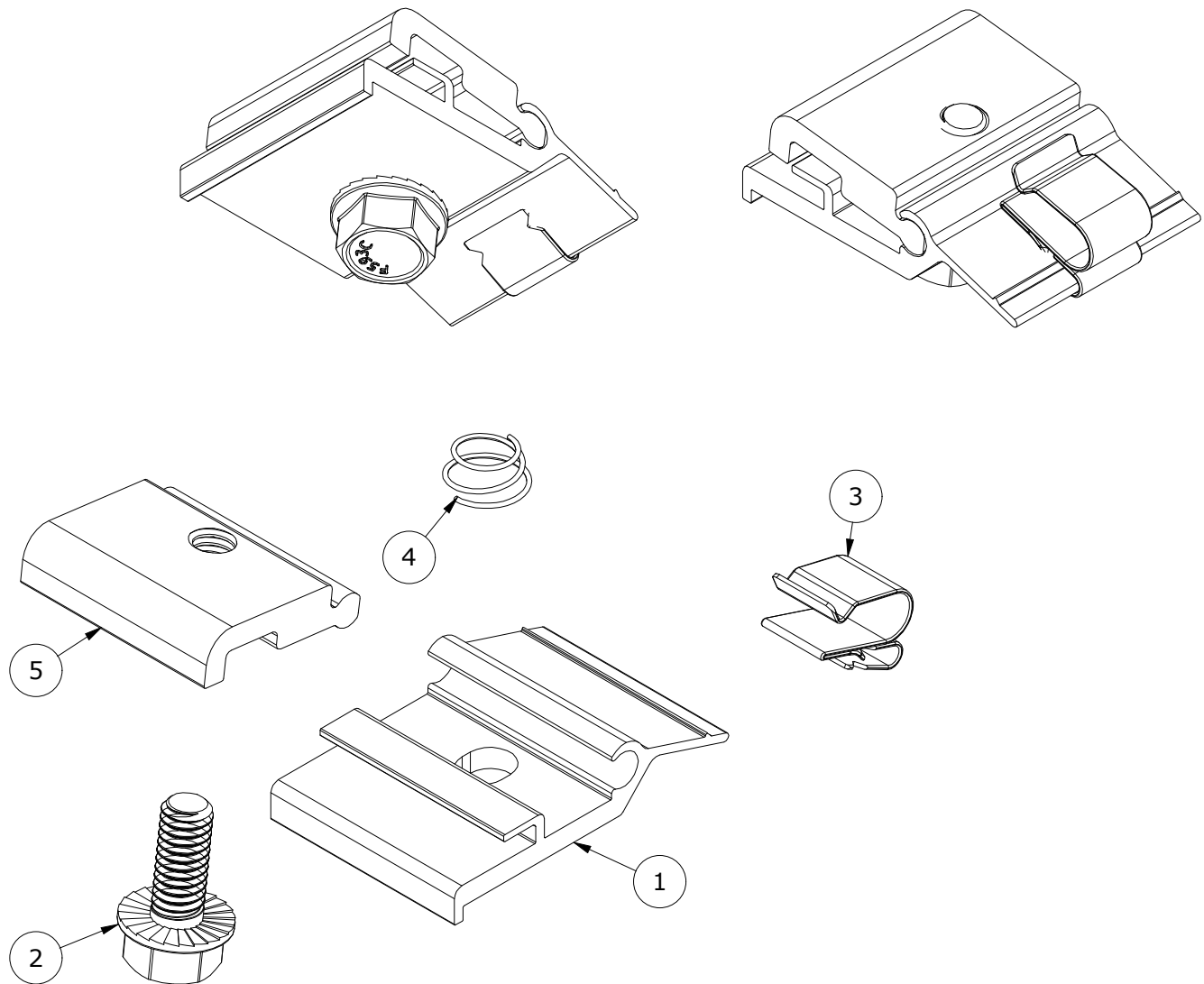

PARTS LIST

ITEM	QTY	DESCRIPTION
1	1	SNAPNRACK, MLPE FRAME ATTACHMENT BOTTOM PRC
2	1	BOLT, FLANGE, 5/16IN-18 X 3/4IN, CLEAR, SS
3	1	SNAPNRACK, SMART CLIP II
4	1	SNAPNRACK, COIL SPRING FOR MLPE FRAME ATTACHMENT
5	1	SNAPNRACK, MLPE FRAME ATTACHMENT TOP PRC

MATERIALS: 6000 SERIES ALUMINUM, STAINLESS STEEL

DESIGN LOAD (LBS): N/A

ULTIMATE LOAD (LBS): N/A

TORQUE SPECIFICATION: 10 FT-LBS

CERTIFICATION: UL 2703, FILE E359313; DOMESTIC CONTENT COMPLIANT

WEIGHT (LBS): 0.13

DESCRIPTION:
SNAPNRACK, TDS, MLPE FRAME ATTACHMENT
KIT (USA)

DOC NUMBER:
SNR-DC-01462

SnapNrack®

PART NUMBER(S):

242-02151-USA

DRAWN BY:
M.WATKINS

REV:

A

DATE:

2/18/2025

SNR SOLAR LLC

775 FIERO LANE, SUITE 200, SAN LUIS OBISPO, CA 93401 USA
EMAIL: CONTACT@SNAPNRACK.COM

THE INFORMATION IN THIS DRAWING IS CONFIDENTIAL AND PROPRIETARY. ANY
REPRODUCTION, DISCLOSURE, OR USE THEREOF IS PROHIBITED WITHOUT THE
WRITTEN CONSENT OF SNR SOLAR LLC.

UNITS: IN, LB, DEG [MM, KG, DEG]

SHEET: 2:2

