



# OMNILUG

242-10034 & 242-10034-USA



MADE IN  
AMERICA

AVAILABLE IN  
"-USA" SKU FOR  
DOMESTIC CONTENT  
QUALIFYING PROJECTS

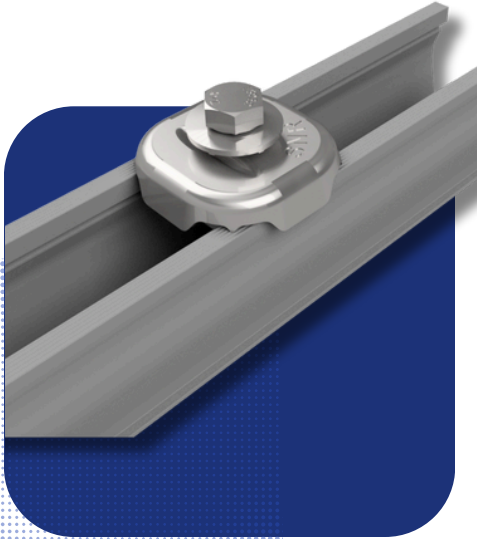

## INNOVATIVE DESIGN

### ALL-IN-ONE SKU

OmniLug is a fusion of our proven Ground Lug & MLPE Rail Attachment by combining both functions into a single, streamlined solution designed to integrate with all SNR systems.

## VERSATILE

### MLPE ATTACHMENT

- Enables the frame of any MLPE device to attach directly to all SnapRack rail & railless tracks.
- Secures the MLPE device & connects the MLPE to the array & system bonding path.

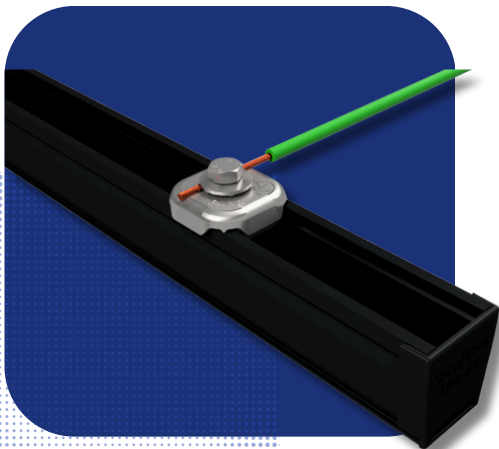

## ULTIMATE

### SYSTEM GROUNDING

- A reliable UL Listed system Ground Lug that provides a secure attachment point for the system grounding conductor.
- Accepts 6-12 awg solid or 8-10 awg stranded copper conductors
- Serves as an attachment point to create a bonding jumper between rails, attachments or arrays to ensure continuous grounding.

**ORDER TODAY**



#### CONTACT SALES

salesupport@snaprack.com  
1 (877) 732-2860, X 1



**MORE INFO ONLINE**  
snaprack.com